

## REPAIRING AND REPLACING OF THE LEFT SIDE HEADSET (WF-1000XM3L)

The left side headset (WF-1000XM3L) will be replaced in the state of the finished product. It can not be repaired by disassembling the left side headset (WF-1000XM3L).

Also, if you replaced the left side headset (WF-1000XM3L), necessary to disassemble the charging case and replace the CASE NFC board at the same time.

When replacing the left side headset (WF-1000XM3L), perform the work for according to the following procedure.

**Note 1:** The repair parts of the left side headset (WF-1000XM3L) are including the CASE NFC board (with NFC sheet, adhesive sheet NFC) paired with the new WF-1000XM3L besides the new WF-1000XM3L.

### Check in advance:

- Check that you have all of the left and right headset (WF-1000XM3L, WF-1000XM3R) and charging case, included in the WF-1000XM3.
- Be sure to check that there are no WF-1000XM3 in the surroundings (within about 50 cm). If using WF-1000XM3 in the surroundings (within about 50 cm), it may connect to another WF-1000XM3.

### Replacing procedure of left side headset (WF-1000XM3L):

1. Replace the broken left side headset with the new left side headset.

**Note 2:** Change the long hybrid silicone rubber earbud or triple-comfort earbud to new WF-1000XM3L from the broken WF-1000XM3L.

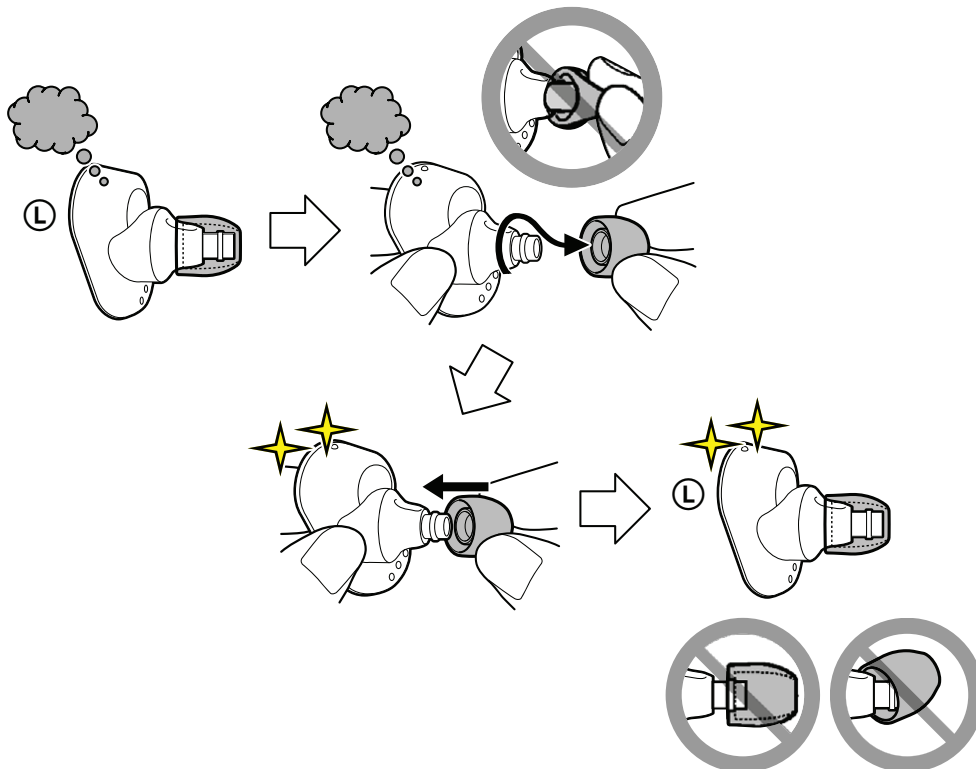

2. Refer to “2. DISASSEMBLY” on page 19, disassemble the charging case and replace the inside CASE NFC board with the new CASE NFC board and assemble as it was before.

(The figure below is an image figure)

**Note 3:** The repair parts of the left side headset are including the CASE NFC board (with NFC sheet, adhesive sheet NFC) paired with the new WF-1000XM3L besides the new WF-1000XM3L.

**Note 4:** If you disassemble the charging case in order to replace the CASE NFC board, reuse the removed parts other than CASE NFC board (with NFC sheet, adhesive sheet NFC), adhesive sheet hall for fixing the case inner block and ornament hinge.

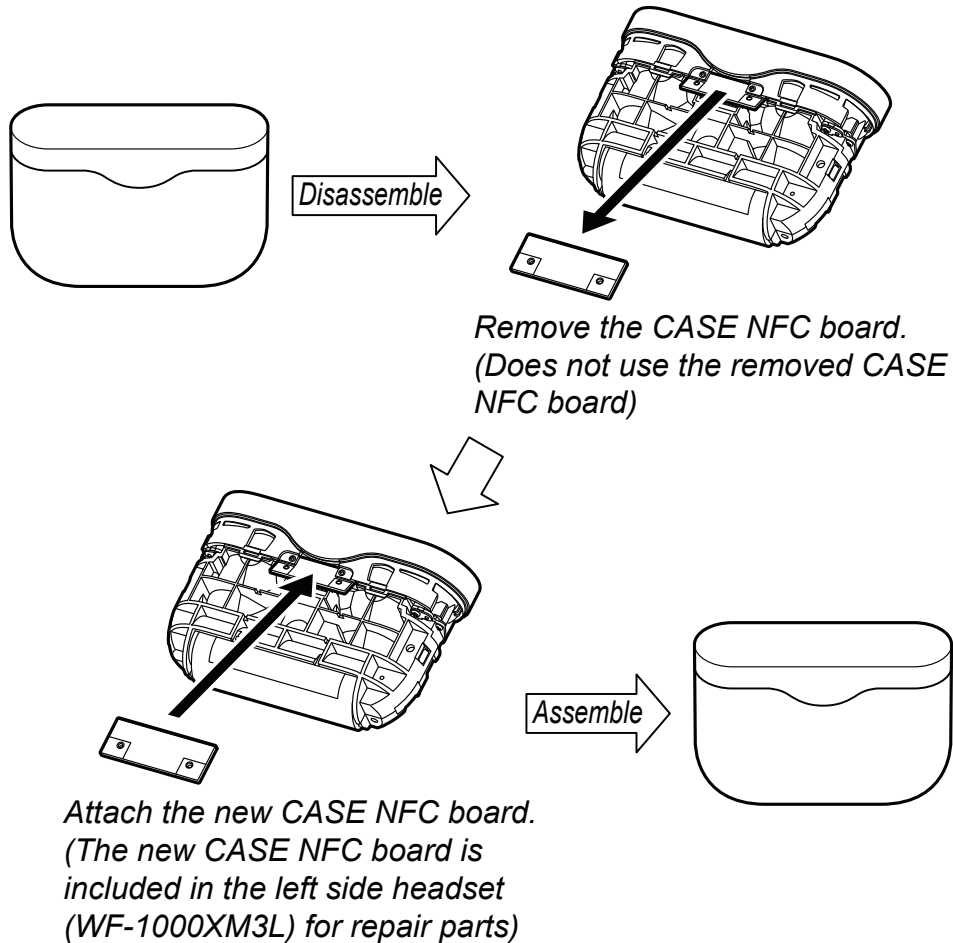

3. Attach the left and right headset to the charging case.

**Note 5:** The left and right headset will display a warning message (3 times red flashing repeat), but proceed to the next step as it is.

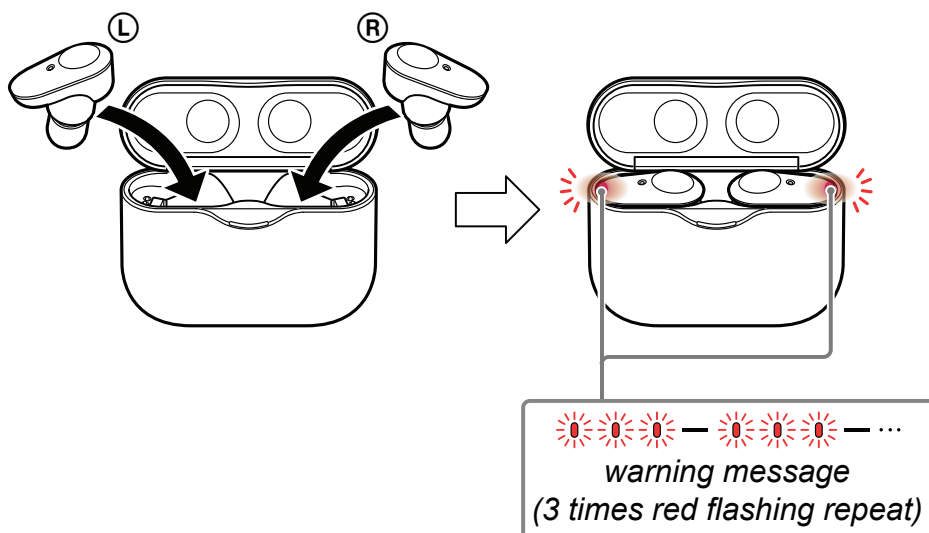

4. Touch and hold the touch sensor control panel on the left and right headset simultaneously, and the indicator changes from warning message (3 times red flashing repeat) to red flashing (slow), in this state release the your finger.

**Note 6:** It takes about 10 seconds to touch and release the touch sensor control panel.

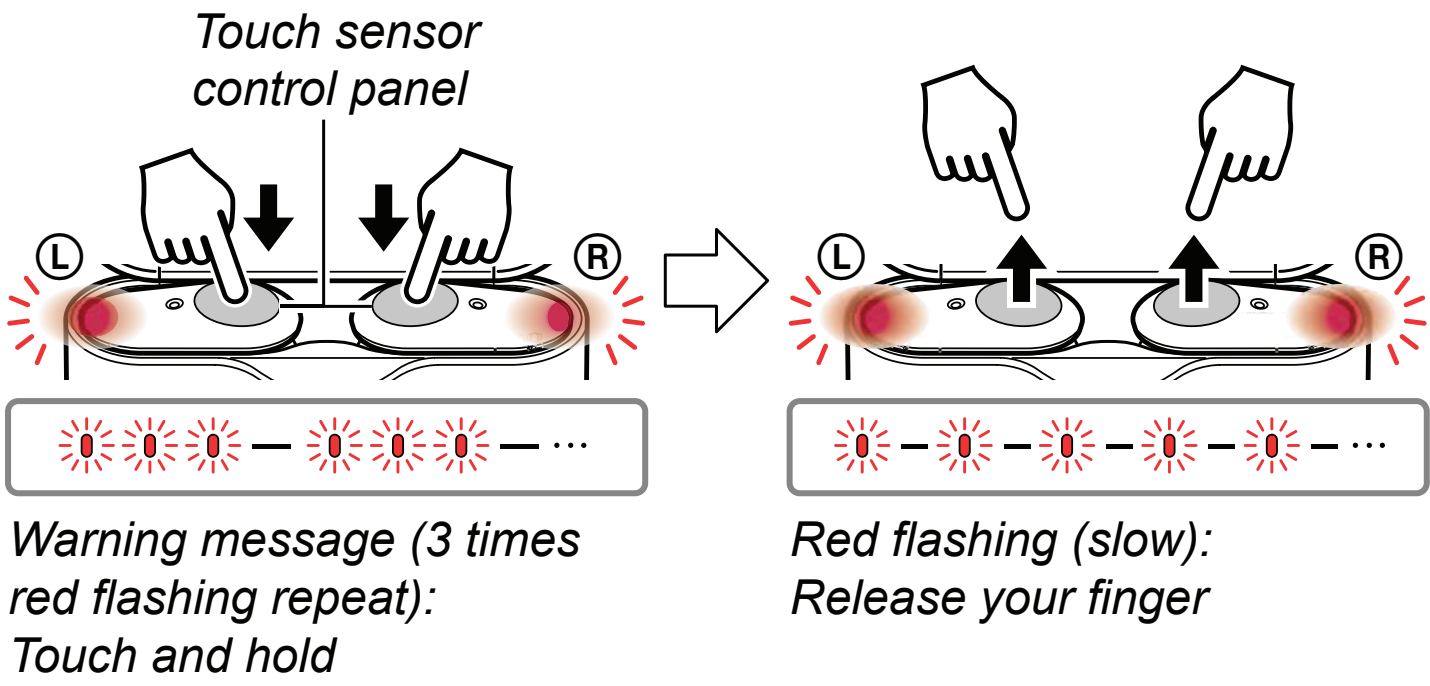

5. The left and right headset indicator automatically changes from red flashing to 4 times of blue flashing, and when the indicator is turn off, pairing of left and right headset is complete.

**Note 7:** When this operation is performed, it might not be able to connect to iPhone or PC.  
In that case, delete the registration of this unit on iPhone or PC, register the device again.

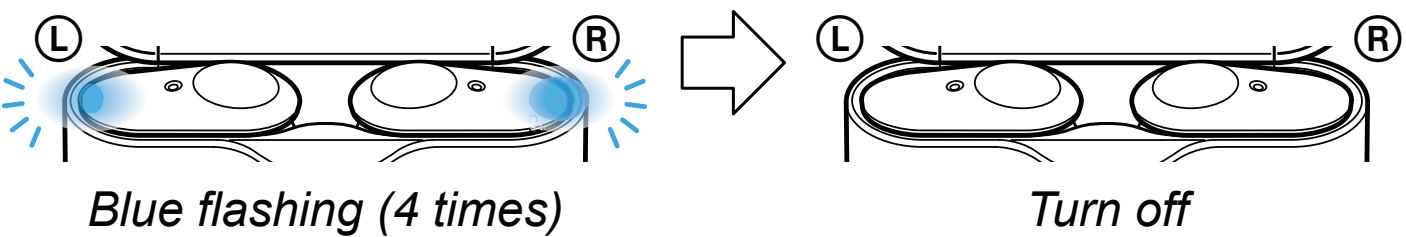

6. Check the operation of this unit and complete the left side headset replacement work.

## 2-1. DISASSEMBLY FLOW

**Note:** It is necessary to disassemble the charging case only when repairing and replacing the left side headset (WF-1000XM3L). This section only describes how to remove the CASE NFC board. For details, refer to “REPAIRING AND REPLACING OF THE LEFT SIDE HEADSET (WF-1000XM3L)” on page 7.

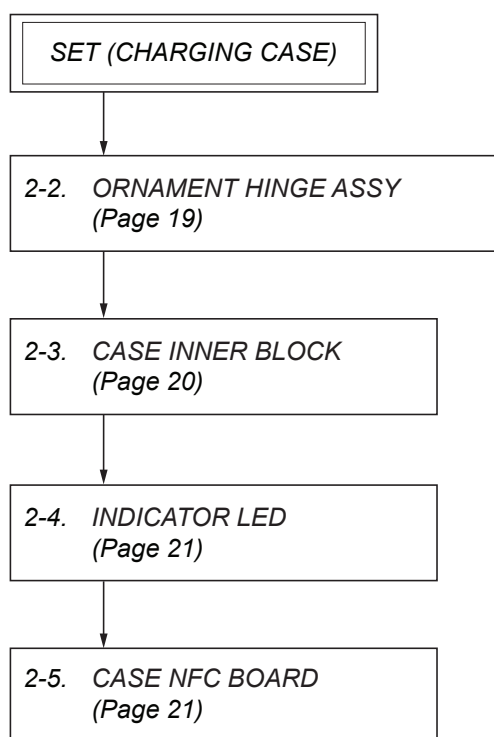

• JIG  
When disassembling the unit, use the following jig.

<u>Part No.</u>	<u>Description</u>
9-913-402-33	TOOL FOR DISASSEMBLING

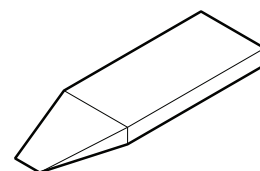

**Note:** Follow the disassembly procedure in the numerical order given.

## 2-2. ORNAMENT HINGE ASSY

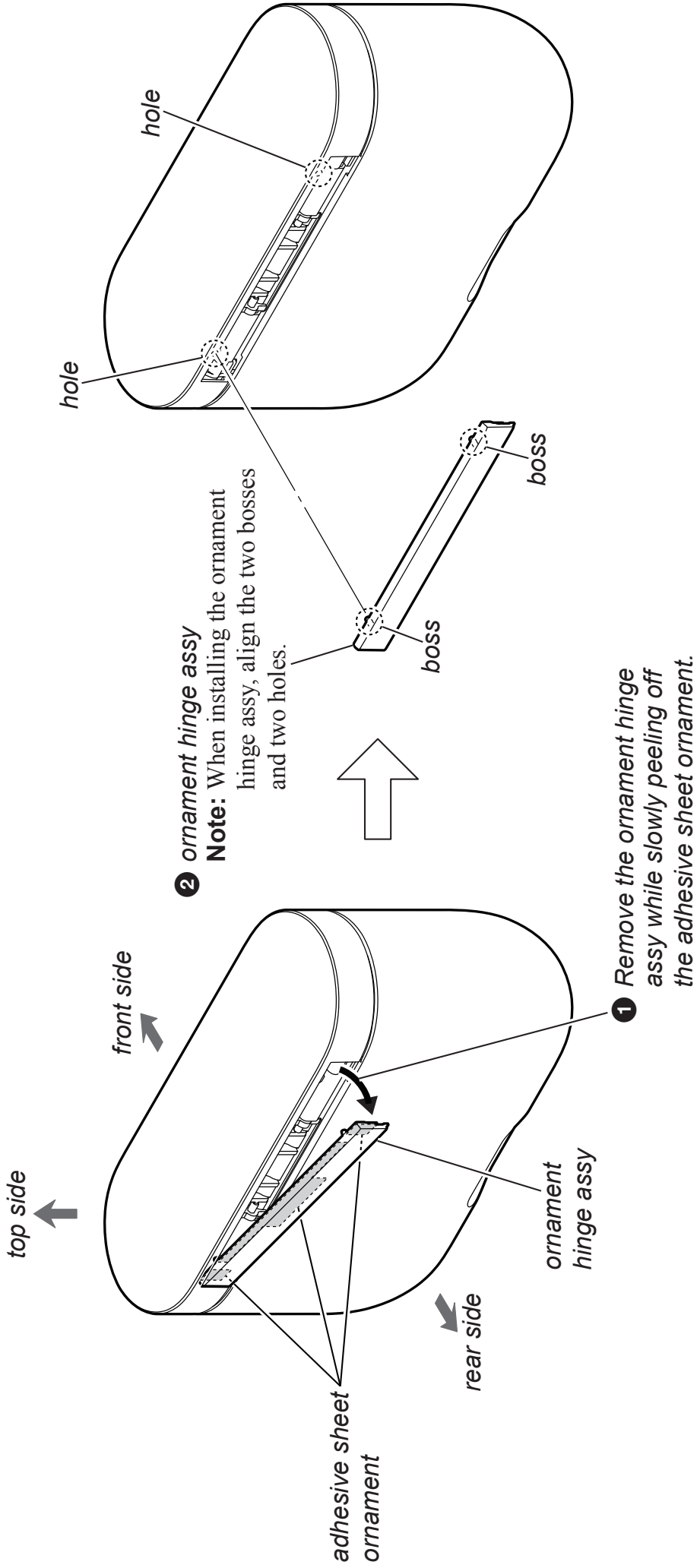

## 2-3. CASE INNER BLOCK

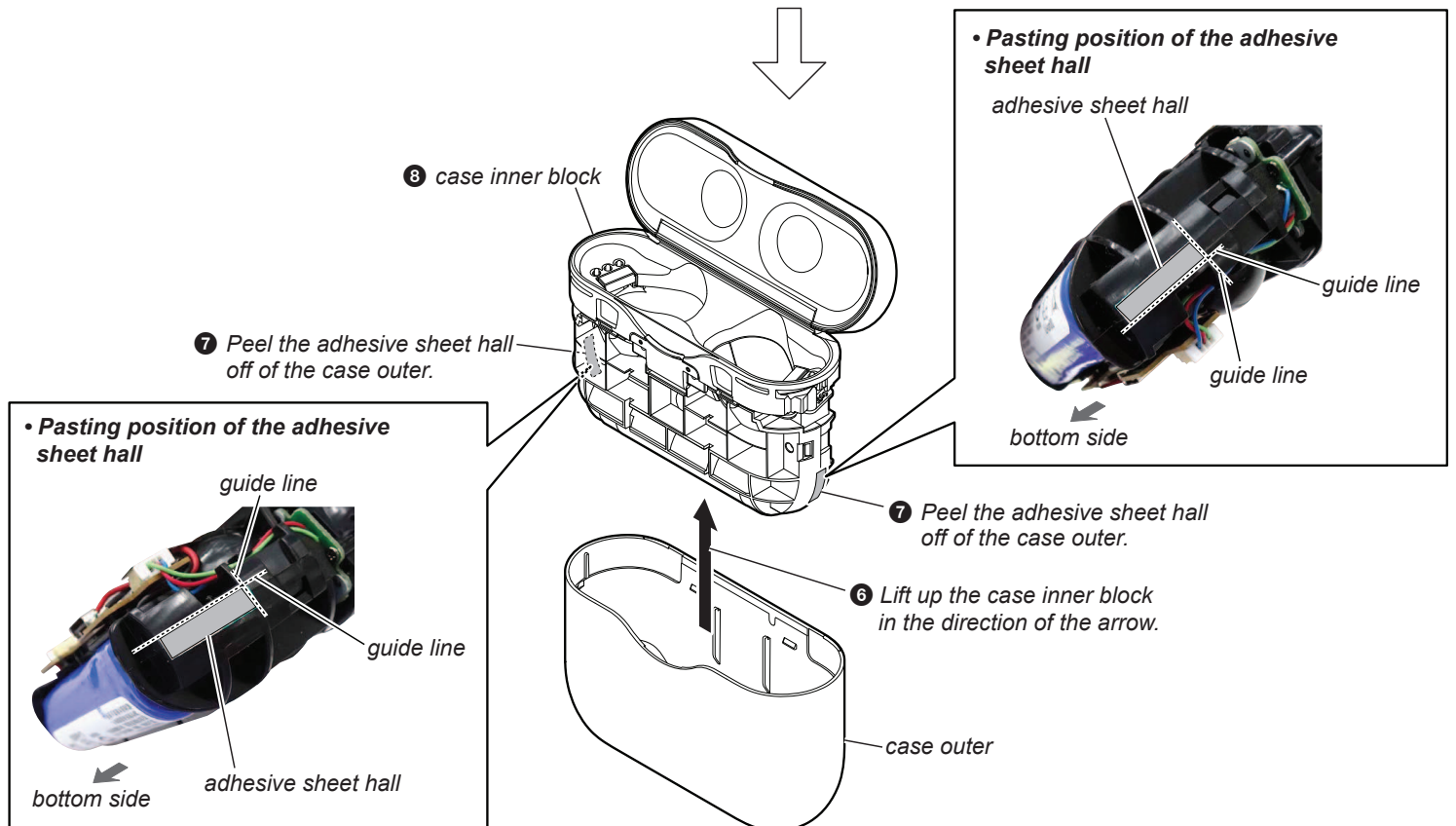
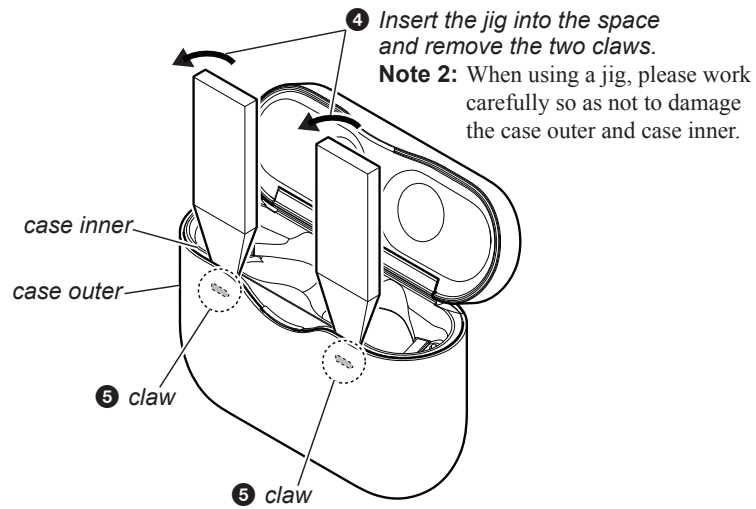
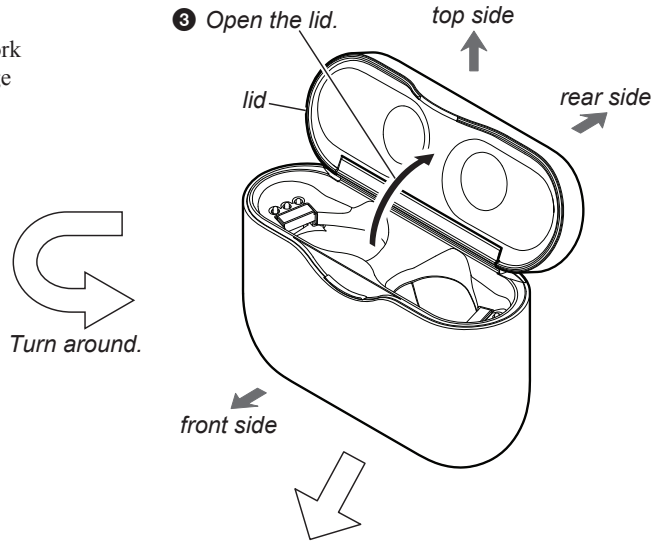
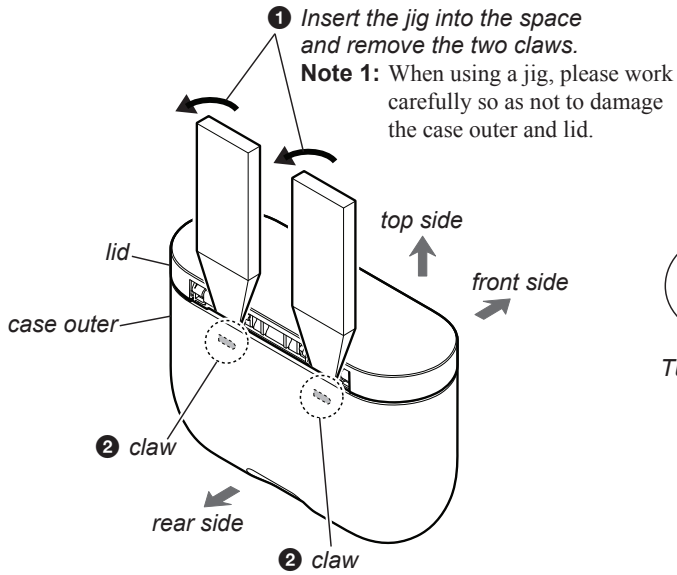

**2-4. INDICATOR LED**

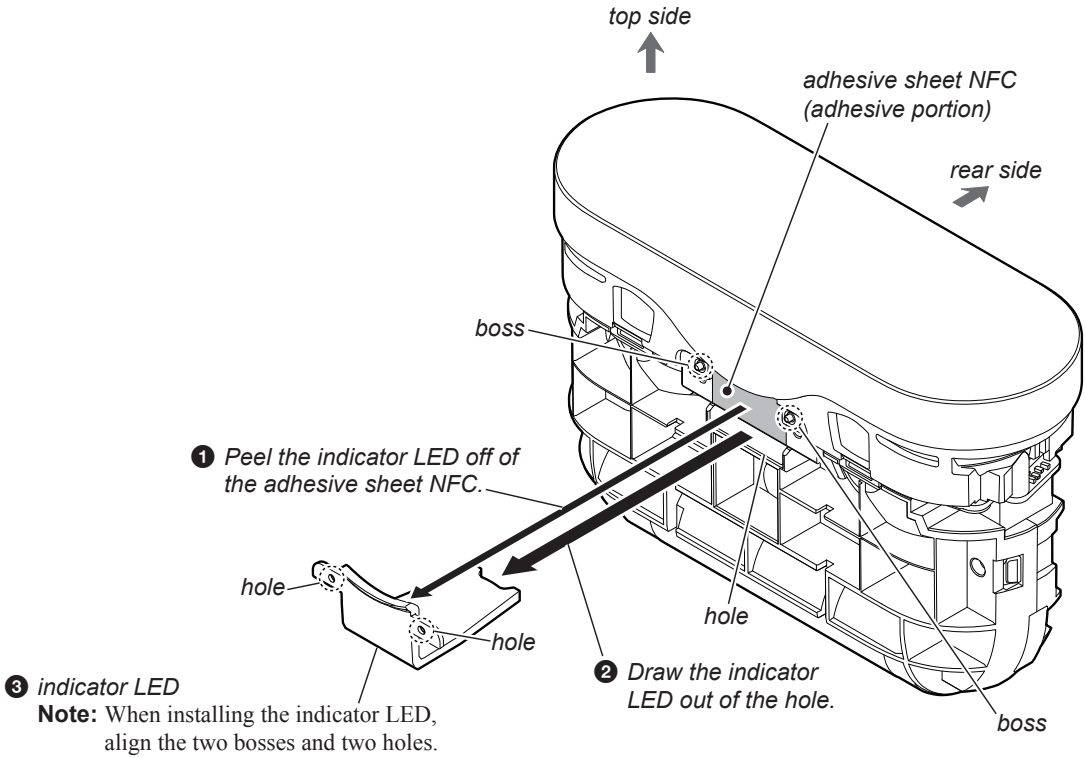

**2-5. CASE NFC BOARD**

